

PORT CONNECTOR

TPC

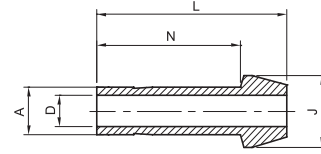

| CONNECTS TWO T-LOK PORTS (METRIC) | | | | | | |
|-----------------------------------|----------------|----|------|------|------|------|
| Part Number | A Tube O.D. | | D | N | L | J |
| | mm | in | in | mm | mm | mm |
| TPC - 3M | 3 | | 2.1 | 15.7 | 22.2 | 6.0 |
| TPC - 6M | 6 | | 4.0 | 18.7 | 25.0 | 9.0 |
| TPC - 8M | 8 | | 6.0 | 20.0 | 25.9 | 11.0 |
| TPC - 10M | 10 | | 7.1 | 20.2 | 27.1 | 13.1 |
| TPC - 12M | 12 | | 8.8 | 26.0 | 36.2 | 15.0 |
| TPC - 16M | 16 | | 12.7 | 27.6 | 37.4 | 19.0 |
| TPC - 18M | 18 | | 13.9 | 27.6 | 37.4 | 21.1 |

| CONNECTS TWO T-LOK PORTS (INCH) | | | | | | | | | | |
|---------------------------------|----------------|-------|------|-------|------|-------|------|-------|------|-------|
| Part Number | A Tube O.D. | | D | | N | | L | | J | |
| | in | mm | in | mm | in | mm | in | mm | in | mm |
| TPC - 1 | 1/16 | 1.58 | 0.03 | 0.75 | 0.42 | 10.72 | 0.54 | 13.72 | 0.13 | 3.30 |
| TPC - 2 | 1/8 | 3.17 | 0.09 | 2.20 | 0.62 | 15.75 | 0.88 | 22.35 | 0.24 | 6.15 |
| TPC - 4 | 1/4 | 6.35 | 0.17 | 4.20 | 0.74 | 18.80 | 0.98 | 24.9 | 0.37 | 9.40 |
| TPC - 5 | 5/16 | 7.93 | 0.24 | 6.00 | 0.79 | 20.11 | 1.02 | 25.91 | 0.43 | 11.00 |
| TPC - 6 | 3/8 | 9.52 | 0.27 | 6.85 | 0.82 | 20.77 | 1.05 | 26.67 | 0.50 | 12.70 |
| TPC - 8 | 1/2 | 12.70 | 0.37 | 9.40 | 1.04 | 26.52 | 1.43 | 36.32 | 0.62 | 15.80 |
| TPC - 12 | 3/4 | 19.05 | 0.59 | 15.00 | 1.11 | 28.25 | 1.49 | 37.85 | 0.87 | 22.10 |
| TPC - 16 | 1 | 25.40 | 0.80 | 20.30 | 1.40 | 35.68 | 1.94 | 49.28 | 1.12 | 28.50 |

Port connector TPC

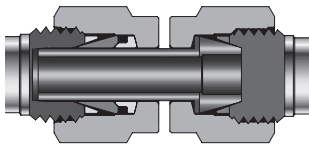

“D” - Dimension is minimum opening - dimensions are for reference only, and are subject to change without notice.
 For 1/16, 1/8 and 3/16 in 2, 3 and 4mm tube fittings, tighten the port connector 1/8 turn.
 For over 1 in and over 25mm tube fittings, tighten the port connector 1/4 turn.