

PLUG

TP

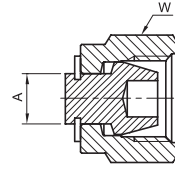

PLUGGING UNUSED PORT OF FITTING (METRIC)			
Part Number	A Tube O.D.		W Hex. flat
	mm		mm
TP - 3M	3		12
TP - 4M	4		12
TP - 6M	6		14
TP - 8M	8		16
TP - 10M	10		19
TP - 12M	12		22
TP - 15M	15		25
TP - 16M	16		25
TP - 18M	18		30
TP - 20M	20		32
TP - 22M	22		32
TP - 25M	25		38
TP - 28M	28		46
TP - 32M	32		50
TP - 38M	38		60
TP - 42M	42		65

PLUGGING UNUSED PORT OF FITTING (INCH)				
Part Number	A Tube O.D.		W Hex. flat	
	in	mm	in	mm
TP - 1	1/16	1.58	5/16	7.9
TP - 2	1/8	3.17	7/16	11.1
TP - 3	3/16	4.76	1/2	12.7
TP - 4	1/4	6.35	9/16	14.3
TP - 5	5/16	7.93	5/8	15.9
TP - 6	3/8	9.52	11/16	17.5
TP - 8	1/2	12.7	7/8	22.2
TP - 10	5/8	15.87	1	25.4
TP - 12	3/4	19.05	1-1/8	28.6
TP - 16	1	25.4	1-1/2	38.1
TP - 20	1-1/4	31.75	1-7/8	47.6
TP - 24	1-1/2	38.1	2-1/4	57.2
TP - 32	2	50.8	3	76.2

PLUG ASSEMBLY INSTRUCTIONS

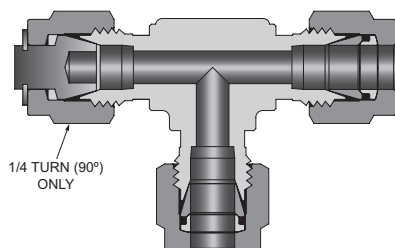

“D” - Dimension is minimum opening - dimensions are for reference only, and are subject to change without notice.
 For 1/16, 1/8 and 3/16 in 2, 3 and 4mm tube fittings, tighten the plug 1/8 turn.
 For over 1 in and over 25mm tube fittings, tighten the plug 1/4 turn.