

TUBE FITTINGS |

MALE PIPE WELD CONNECTOR

TMPWC

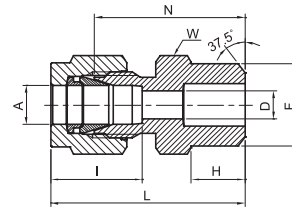

TUBE (METRIC) TO PIPE (INCH)												
Part Number	A Tube O.D.		F Pipe size		D		W Hex. flat		N	H	L	I
	mm	in	mm	in	mm	in	mm	in	mm	mm	mm	mm
TMPWC - 3M - 2TW	3	1/8	10.30	2.4	12	23.1	9.7	30.5	12.9			
TMPWC - 4M - 2TW	4	1/8	10.30	2.4	12	24.1	9.7	31.2	13.7			
TMPWC - 6M - 2TW	6	1/8	10.30	4.8	14	25.4	9.7	32.8	15.3			
TMPWC - 6M - 4TW	6	1/4	13.70	4.8	14	30.2	14.2	37.9	15.3			
TMPWC - 8M - 2TW	8	1/8	10.30	5.1	15	26.7	9.7	34.2	16.2			
TMPWC - 8M - 4TW	8	1/4	13.70	6.4	15	31.2	14.2	38.7	16.2			
TMPWC - 8M - 8TW	8	1/2	21.34	6.4	22	37.3	19.0	45.6	16.2			
TMPWC - 10M - 4TW	10	1/4	13.70	7.1	18	33.3	14.2	40.9	17.2			
TMPWC - 10M - 6TW	10	3/8	17.10	7.9	18	32.5	14.2	40.9	17.2			
TMPWC - 10M - 8TW	10	1/2	21.34	7.9	22	38.1	19.0	46.5	17.2			
TMPWC - 12M - 4TW	12	1/4	13.70	7.1	22	33.3	14.2	43.4	22.8			
TMPWC - 12M - 6TW	12	3/8	17.10	9.5	22	33.3	14.2	43.4	22.8			
TMPWC - 12M - 8TW	12	1/2	21.34	9.5	22	38.1	19.0	49.0	22.8			
TMPWC - 15M - 8TW	15	1/2	21.34	11.9	24	38.9	19.0	49.0	24.4			
TMPWC - 16M - 8TW	16	1/2	21.34	12.7	24	38.9	19.0	49.0	24.4			
TMPWC - 18M - 8TW	18	1/2	21.34	13.5	27	40.4	19.0	50.5	24.4			

TUBE (INCH) TO PIPE (INCH)																
Part Number	A Tube O.D.		F Pipe size		D		W Hex. flat		N		H		L		I	
	in	mm	in	mm	in	mm	in	mm	in	mm	in	mm	in	mm	in	mm
TMPWC - 2 - 2TW	1/8	3.17	1/8	10.30	0.09	2.28	7/16	11.1	0.94	23.88	0.38	9.65	1.20	30.48	0.50	12.7
TMPWC - 3 - 2TW	3/16	4.76	1/8	10.30	0.12	3.04	7/16	11.1	0.97	24.60	0.38	9.65	1.23	31.25	0.54	13.7
TMPWC - 4 - 2TW	1/4	6.35	1/8	10.30	0.19	4.82	1/2	12.7	1.00	25.40	0.38	9.65	1.29	32.77	0.60	15.3
TMPWC - 4 - 4TW	1/4	6.35	1/4	13.70	0.19	4.82	9/16	14.3	1.19	30.22	0.56	14.22	1.48	37.59	0.60	15.3
TMPWC - 5 - 2TW	5/16	7.93	1/8	10.30	0.20	5.08	9/16	14.3	1.05	26.67	0.38	9.65	1.34	34.04	0.64	16.2
TMPWC - 5 - 4TW	5/16	7.93	1/4	13.70	0.25	6.35	9/16	14.3	1.23	31.24	0.56	14.22	1.52	38.61	0.64	16.2
TMPWC - 6 - 4TW	3/8	9.52	1/4	13.70	0.28	7.11	5/8	15.9	1.28	32.51	0.56	14.22	1.57	39.87	0.66	16.9
TMPWC - 6 - 6TW	3/8	9.52	3/8	17.10	0.28	7.11	11/16	17.5	1.28	32.51	0.56	14.22	1.57	39.87	0.66	16.9
TMPWC - 6 - 8TW	3/8	9.52	1/2	21.34	0.28	7.11	7/8	22.2	1.53	38.86	0.75	19.05	1.82	46.22	0.66	16.9
TMPWC - 8 - 6TW	1/2	12.70	3/8	17.10	0.41	10.41	13/16	20.6	1.31	33.27	0.56	14.22	1.71	44.43	0.90	22.9
TMPWC - 8 - 8TW	1/2	12.70	1/2	21.34	0.41	10.41	7/8	22.2	1.53	38.86	0.75	19.05	1.93	49.00	0.90	22.9
TMPWC - 8 - 12TW	1/2	12.70	3/4	26.67	0.41	10.41	1-1/16	27.0	1.59	40.40	0.75	19.05	1.99	50.55	0.90	22.9
TMPWC - 10 - 8TW	5/8	15.87	1/2	21.34	0.50	12.70	15/16	23.8	1.53	38.86	0.75	19.05	1.93	49.02	0.96	24.4
TMPWC - 12 - 12TW	3/4	19.05	3/4	26.67	0.62	15.74	1-1/16	27.0	1.59	40.40	0.75	19.05	1.99	50.55	0.96	24.5
TMPWC - 16 - 16TW	1	25.4	1	33.4	0.88	22.35	1-3/8	34.9	1.97	50.03	0.94	23.87	2.45	62.23	1.23	31.2
TMPWC - 20 - 20TW	1-1/2	31.75	1-1/4	42.16	1.09	22.7	1-3/4	44.5	2.17	55.12	0.94	23.88	3.04	77.22	1.62	41.2
TMPWC - 24 - 24TW	1-1	38.1	1-1/2	48.26	1.34	34	2-1/8	54.0	2.43	61.72	1.03	26.16	3.5	88.9	1.97	50.0
TMPWC - 32 - 32TW	2	50.8	2	60.33	1.81	45.97	2-3/4	69.9	3.0	76.2	1.06	26.92	4.47	113.34	2.66	67.6

“D” - Dimension is the minimum opening. These fittings may have a larger opening at the weld end. The wall thickness of welding edge is based on SCH 80.