

# FEMALE BRANCH TEE

TFBT

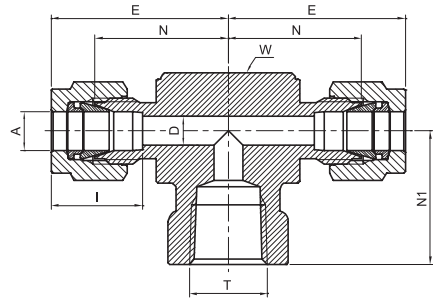
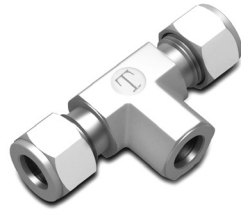

TUBE (METRIC) TO FEMALE NPT THREAD											
Part Number	A Tube O.D.		T NPT	D		W Wrench flat		N	E	N1	I
	mm	in	in	mm	in	mm	mm	mm	mm	mm	mm
TFBT - 6M - 2N	6		1/8	4.8		1/2	12.7	19.6	27.0	19.0	15.3
TFBT - 6M - 4N	6		1/4	4.8		11/16	17.5	22.4	29.8	22.4	15.3
TFBT - 6M - 6N	6		3/8	4.8		13/16	20.6	24.4	31.7	22.4	15.3
TFBT - 6M - 8N	6		1/2	4.8		1	25.4	27.2	34.5	28.4	15.3
TFBT - 8M - 2N	8		1/8	6.4		5/8	15.9	23.1	29.9	19.0	16.2
TFBT - 8M - 4N	8		1/4	6.4		11/16	17.5	23.1	30.6	22.4	16.2
TFBT - 8M - 6N	8		3/8	6.4		13/16	20.6	25.2	32.4	22.4	16.2
TFBT - 8M - 8N	8		1/2	6.4		1	25.4	28.0	35.2	28.4	16.2
TFBT - 10M - 4N	10		1/4	7.9		13/16	20.6	25.9	33.5	22.4	17.2
TFBT - 10M - 6N	10		3/8	7.9		13/16	20.6	25.9	33.5	22.4	17.2
TFBT - 10M - 8N	10		1/2	7.9		1	25.4	28.7	36.1	22.4	17.2
TFBT - 12M - 4N	12		1/4	9.5		13/16	20.6	25.9	36.0	22.4	22.8
TFBT - 12M - 6N	12		3/8	9.5		13/16	20.6	25.9	36.0	22.4	22.8
TFBT - 12M - 8N	12		1/2	9.5		1	25.4	28.7	38.8	28.4	22.8
TFBT - 16M - 8N	16		1/2	12.7		1	25.4	28.7	38.8	28.4	24.4

TUBE (INCH) TO FEMALE NPT THREAD															
Part Number	A Tube O.D.		T NPT	D		W Wrench flat		N		E		N1		I	
	in	mm	in	in	mm	in	mm	in	mm	in	mm	in	mm	in	mm
TFBT - 2 - 2N	1/8	3.17	1/8	0.09	2.28	1/2	12.7	0.70	18.00	0.97	24.64	0.75	19.05	0.50	12.7
TFBT - 4 - 2N	1/4	6.35	1/8	0.19	4.82	1/2	12.7	0.77	19.56	1.06	26.96	0.75	19.05	0.60	15.3
TFBT - 4 - 4N	1/4	6.35	1/4	0.19	4.82	11/16	17.5	0.88	22.35	1.17	29.71	0.88	22.35	0.60	15.3
TFBT - 6 - 4N	3/8	9.52	1/4	0.28	7.11	11/16	17.5	0.94	23.88	1.23	31.24	0.88	22.35	0.66	16.9
TFBT - 8 - 4N	1/2	12.70	1/4	0.41	10.41	13/16	20.6	1.02	25.90	1.42	36.07	0.88	22.35	0.90	22.9
TFBT - 8 - 6N	1/2	12.70	3/8	0.41	10.41	13/16	20.6	1.02	25.90	1.42	36.07	0.88	22.35	0.90	22.9
TFBT - 8 - 8N	1/2	12.70	1/2	0.41	10.41	1-1/8	1	25.4	28.70	1.53	38.86	1.12	28.45	0.90	22.9
TFBT - 10 - 8N	5/8	15.87	1/2	0.50	12.70	1-1/8	1	25.4	28.70	1.53	38.86	1.12	28.44	0.96	24.4
TFBT - 12 - 12N	3/4	19.05	3/4	0.62	15.74	1-3/8	34.9	1.36	34.50	1.76	44.70	1.25	31.75	0.96	24.5
TFBT - 16 - 12N	1	25.40	3/4	0.88	22.35	1-3/8	34.9	1.45	36.83	1.93	49.02	1.25	31.75	1.23	31.2
TFBT - 16 - 16N	1	25.40	1	0.88	22.35	1-11/16	42.9	1.63	41.40	2.11	53.60	1.50	38.10	1.23	31.2

"D" - Dimension is minimum opening - dimensions are for reference only, and are subject to change without notice.