

Dk-Lok Tube Fittings

Male Pipe Weld Elbow DLW

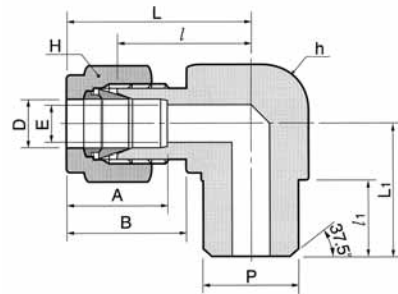

Connects fractional tube to pipe

| Part No. | Tube O.D. | | Male Pipe Size | | E Min. | Width across flat | | | | A | B | <i>l</i> | <i>l</i> ₁ | L | L ₁ |
|------------|-----------|-------|----------------|-------|-----------|-------------------|-------|-------|-------|-------|-------|----------|-----------------------|-------|----------------|
| | D | | P | | | h | | H | | | | | | | |
| | in | mm | Nom. | O.D. | | in | mm | in | mm | | | | | | |
| DLW 2-2P | 1/8 | 3.17 | 1/8 | 10.29 | 4.82 | 1/2 | 12.70 | 9/16 | 14.28 | 15.24 | 17.78 | 19.55 | 9.65 | 26.92 | 18.79 |
| DLW 4-4P | 1/4 | 6.35 | 1/4 | 13.72 | 4.82 | 1/2 | 12.70 | 9/16 | 14.28 | 15.24 | 17.78 | 19.55 | 14.22 | 26.92 | 23.36 |
| DLW 6-4P | 3/8 | 9.52 | 1/4 | 13.72 | 7.11 | 5/8 | 15.87 | 11/16 | 17.46 | 16.76 | 19.30 | 23.11 | 14.22 | 30.48 | 25.40 |
| DLW 8-8P | 1/2 | 12.70 | 1/2 | 21.34 | 10.41 | 13/16 | 20.64 | 7/8 | 22.22 | 22.86 | 21.84 | 25.90 | 19.05 | 36.06 | 33.02 |
| DLW 12-12P | 3/4 | 19.05 | 3/4 | 26.67 | 15.74 | 1-1/16 | 26.98 | 1-1/8 | 28.58 | 24.38 | 21.84 | 29.71 | 19.05 | 39.87 | 36.83 |

Dk-Lok Welding information

Dk-Lok weld ends are constructed to SCH. 80 or greater.

1. Remove the nut and ferrules from the Dk-Lok port.
 - This protects the nut and ferrules from weld heat.
2. Cover the Dk-Lok port threads with a protective device such as Dk-Lok Plug (DP).
 - This protects threads and sealing surface on the Dk-Lok port.
 - Finger-tighten the DP to use it many times.
3. Tack weld at four positions 90 degree apart.
 - This holds the fitting in alignment and concentricity.
4. Complete the welding.
5. Remove the protective device and replace the nut and ferrules.