

HIGH PRESSURE MANUAL DIAPHRAGM VALVE

STD TYPE**MAJOR SPECIFICATIONS**

Size	1/4"
Cv Value	0.1
Orifice Size	2.3mm
Max. Working Pressure (G.)	23.5MPa
Max. Working Temp.	-10°C ~ 40°C
Internal Leakage Allowance (He)	1x10 ⁻¹⁰ Pa · m ³ /s
Test Pressure ≤ 1×10⁻² Torr	
Holding Time ≥ 30 sec.	
External Leakage Allowance (He)	1x10 ⁻¹⁰ Pa · m ³ /s
Test Pressure ≤ 1×10⁻² Torr	
Holding Time ≥ 1 min.	
Particle Inspection (EP only) Pressure : 60~80psi N ₂ Gas Sample Volume : 1CFM 0.1µm and Larger	No count

PRODUCT GRADE

GRADE	AP	BA	EP
Inner Surface Roughness	Ry ≤ 25µm Cut off Length : 2.5mm Measuring Length : 12.5mm	Ry ≤ 3.0µm 10 µinch Ra(Avg.) Cut off Length : 0.8mm Measuring Length : 4mm	Ry ≤ 0.7µm 5 µinch Ra(Avg.) Cut off Length : 0.25mm Measuring Length : 1.25mm
Polishing	Machining Finish	Machining Finish	Electro Polishing Finish

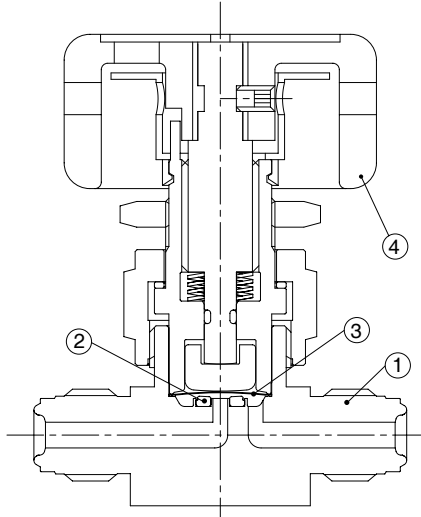

MATERIAL

NO.	NAME	MATERIAL
1	Body	316L Stainless Steel 316L Stainless Steel VAR 304 Stainless Steel
2	Seat	PCTFE
3	Diaphragm	Ni-Co Alloy
4	Handle	Aluminum

ORDERING INFORMATION

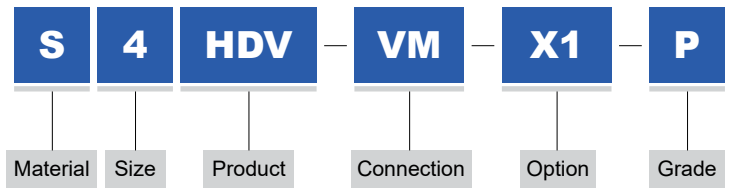

MATERIAL		SIZE		CONNECTION		GRADE	
S	316L Stainless Steel	4	1/4"	VM	MFS Male	AP	AP Grade
D	316L Stainless Steel VAR			VF	MFS Female	BLANK	BA Grade
4S	304 Stainless Steel			SW	Lok	P	EP Grade
				TW	Butt Weld		

MODEL	CONNECTION	A	B	C	D	E	F	G	H	I	J
	MFS Male	57	11	74	48	28	25.4	28.5	3.5	M5	
	MFS Female	70.6	11	74	48	28	25.4	28.5	3.5	M5	
	Lok	55	11	74	48	28	25.4	28.5	3.5	M5	69.3
	Butt Weld	135	11	74	48	28	25.4	28.5	3.5	M5	