

LOW PRESSURE MANUAL BELLOWS VALVE

STD TYPE

FEATURES

- Minimize the dead space
- Installation can be made either panel-mount or bottom-mount
- Handle with open/close indicator is standardized



MAJOR SPECIFICATIONS

Size	1/4"	3/8", 1/2"	3/4"
Cv Value	0.36	1.1	2.6
Orifice Size	4.5mm	8mm	12mm
Max. Working Pressure (G.)	1MPa		
Max. Working Temp.	PCTFE : -10°C ~ 80°C / PI : -10°C ~ 150°C		
Internal Leakage Allowance (He)	4x10 ⁻¹⁰ Pa · m ³ /s		
Test Pressure ≤ 1×10⁻² Torr			
Holding Time ≥ 30 sec.			
External Leakage Allowance (He)	4x10 ⁻¹⁰ Pa · m ³ /s		
Test Pressure ≤ 1×10⁻² Torr			
Holding Time ≥ 1 min.			
Particle Inspection (EP only)	No count		
Pressure : 60~80psi N₂ Gas			
Sample Volume : 1CFM			
0.1μm and Larger			

PRODUCT GRADE

GRADE	AP	BA	EP
Inner Surface Roughness	Ry ≤ 25μm Cut off Length : 2.5mm Measuring Length : 12.5mm	Ry ≤ 3.0μm 10 μinch Ra(Avg.) Cut off Length : 0.8mm Measuring Length : 4mm	Ry ≤ 0.7μm 5 μinch Ra(Avg.) Cut off Length : 0.25mm Measuring Length : 1.25mm
Polishing	Machining Finish	Machining Finish	Electro Polishing Finish

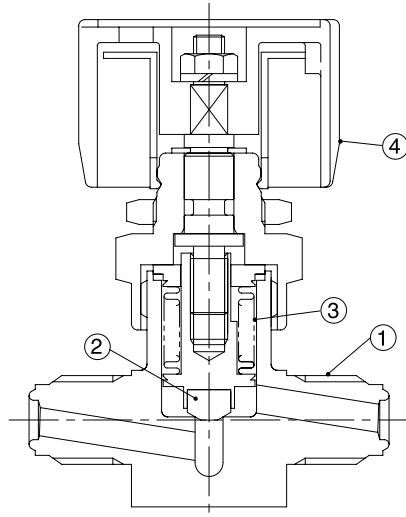

MATERIAL

NO.	NAME	MATERIAL
1	Body	316L Stainless Steel 316L Stainless Steel VAR 304 Stainless Steel
2	Disk	PCTFE / PI
3	Bellows	316L Stainless Steel
4	Handle	1/4" ~ 1/2" : HI-100, 3/4" : Aluminum

ORDERING INFORMATION

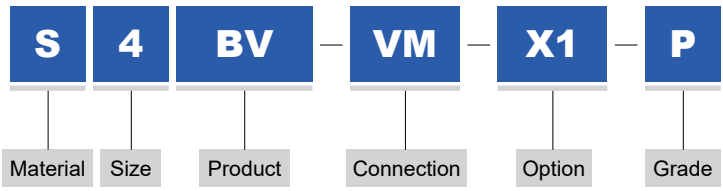

MATERIAL		SIZE		CONNECTION		OPTION		GRADE	
S	316L Stainless Steel	4	1/4"	VM	MFS Male	X259	PI Disk	AP	AP Grade
D	316L Stainless Steel VAR	6	3/8"	VF	MFS Female			BLANK	BA Grade
4S	304 Stainless Steel	8	1/2"	SW	Lok			P	EP Grade
		12	3/4"	TW	Butt Weld				

MODEL	CONNECTION	SIZE	A	B	C	D	E	F	G	H	J	L
	MFS Male	1/4"	58	14	79	45	23	25	30	2	18.5	
		3/8"	60	16	85	45	23	25	36.5	2	18.5	
		1/2"	60	16	85	45	23	25	36.5	2	18.5	
		3/4"	125	22	124	65	32	33	58	6	24	
	MFS Female	1/4"	70.5	14	79	45	23	25	30	2	18.5	
		3/8"	90	14	85	45	23	25	36.5	2	18.5	
		1/2"	90	14	85	45	23	25	36.5	2	18.5	
		3/4"	115	22	124	65	32	33	58	6	24	
	Lok	1/4"	50	14	79	45	23	25	30	2	18.5	64
		3/8"	63	14	85	45	23	25	36.5	2	18.5	78
		1/2"	63	14	85	45	23	25	36.5	2	18.5	83.5
		3/4"	80	22	124	65	32	33	58	6	24	101
	Butt Weld	1/4"	150	14	85	45	23	25	36.5	2	18.5	
		3/8"	150	14	85	45	23	25	36.5	2	18.5	
		1/2"	150	14	85	45	23	25	36.5	2	18.5	
		3/4"	158	22	124	65	32	33	58	6	24	